

Installation instructions for profiles CONECTO Sinus 06NC50-R

1. Before installation, cut the concrete (and the upper part of the expansion profile, if previously installed) on both sides of the crack to a width of at least 250mm and a depth covering the extent of damage (min. 50mm). The installation site should be cleaned of any, especially unrelated to the ground, contamination.

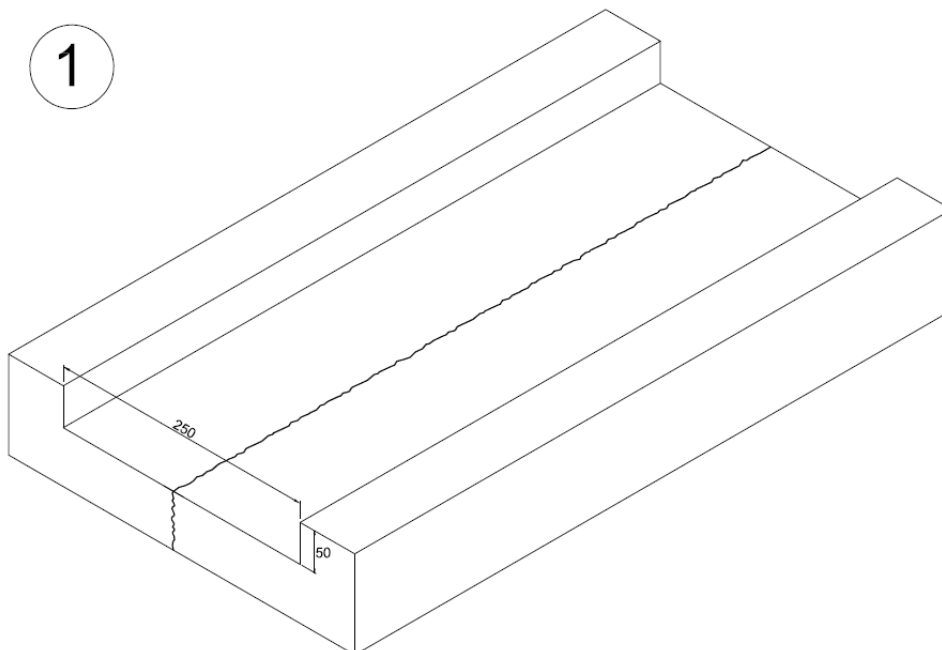

fig. 1 Prepared niche in concrete for the repair profile

2. Place the profile exactly above the expansion joint and level it so that the top of the profile is at the target height of the upper floor level. In addition, the profile can be placed on an expansion cord mounted along the exposed gap.

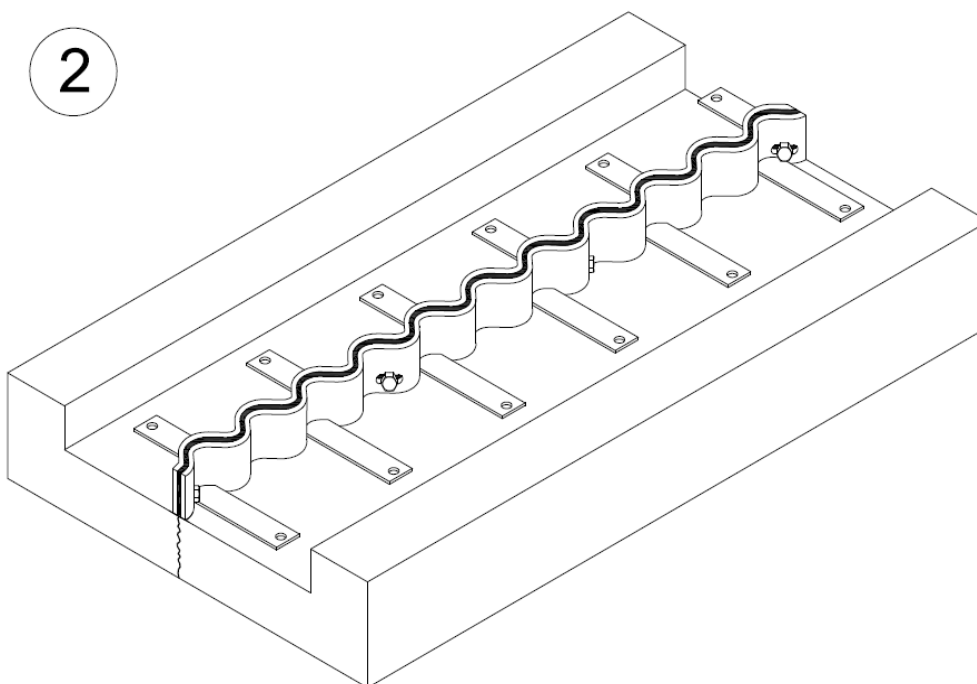

fig. 2 Profile setting

3. Stabilize the profile, e.g. with rods of diameter $\varnothing 10$ (point 5) or leveling screws M10 (point 4) with machine thread on pins, so that the profile does not move during concreting. To do this, drill holes for the $\varnothing 10$ bar in the concrete just under the holes in the support feet. Then place the rods so that they pass through the holes in the feet.

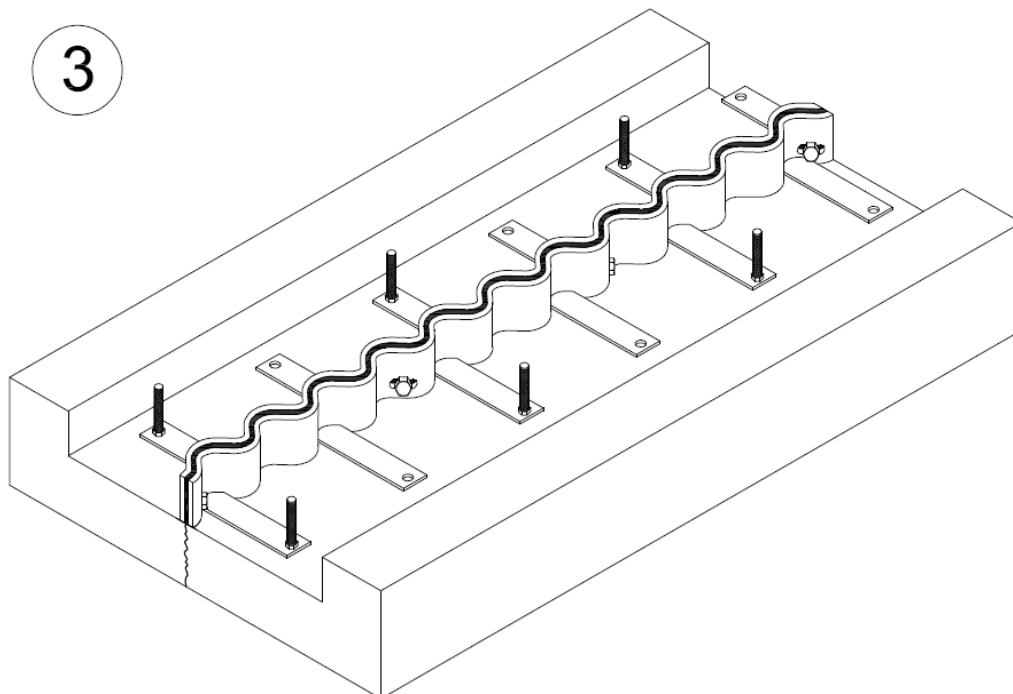

fig. 3 Profile stabilization

4. Using a spirit level and nuts placed above and below your feet, level the profile.

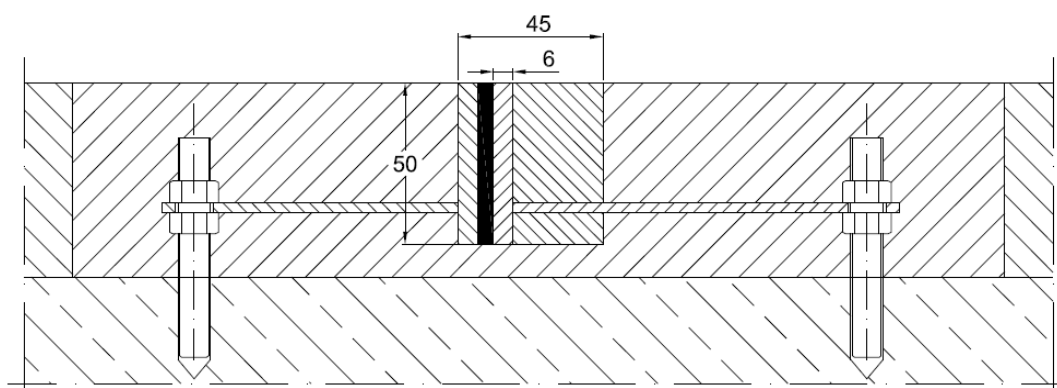
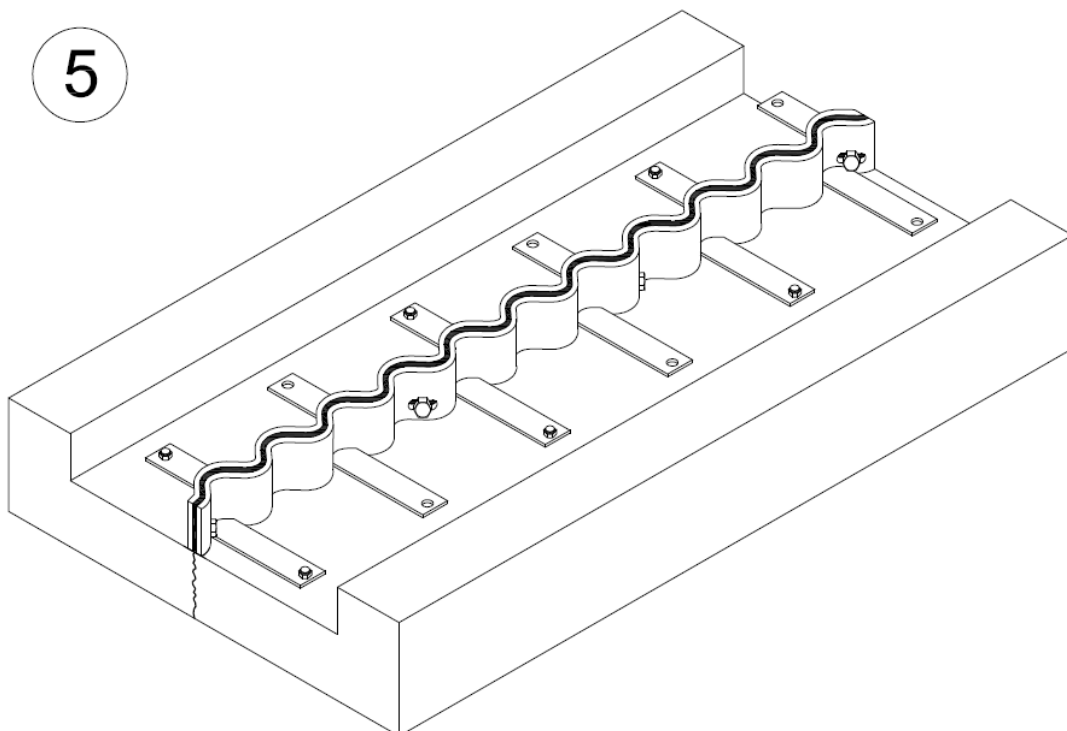
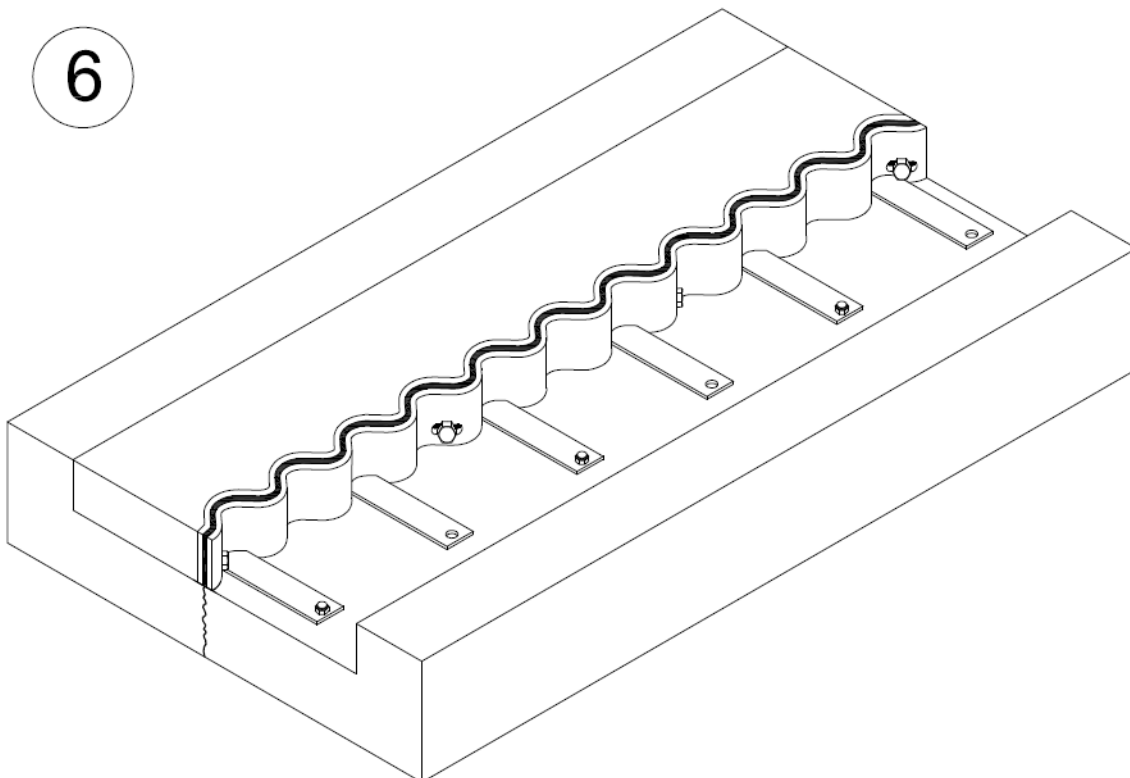

Fig 4 Profile leveling

5. Stabilizing elements (reinforcing bars anchored to the ground) should be welded to the supporting feet, and then cut just above the feet, so that after pouring the mortar they are below the floor level. The upper surface of the profile should coincide with the level "0" of the floor or the target height.



6. Pour one side with low-shrinkage repair mortar or reinforced concrete with a strength not less than the floor.



7. Complete the other side of the profile with concrete. After pre-setting, the surface is rubbed smoothly and polished. Finally, we recommend impregnation of the floor to protect against dust and contamination.

