

Technical Data sheet concrete Trapezium-shaped surface spacer in quality level Q1

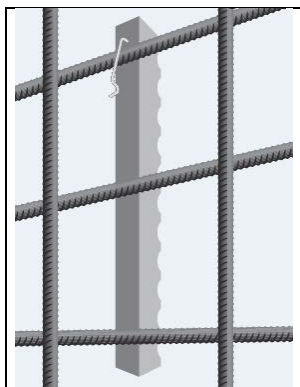

Article Nr.	Height mm	Palette Pieces	Palette kg
3020/25/340/BD/FK1/Q1	25	2400	779
3021/30/340/BD/FK1/Q1	30	1800	751
3022/35/340/BD/FK1/Q1	35	1600	790
3023/40/340/BD/FK1/Q1	40	1300	777
3024/45/340/BD/FK1/Q1	45	1200	809
3025/50/340/BD/FK1/Q1	50	1100	826
3026/55/340/BD/FK1/Q1	55	1000	918
3027/60/340/BD/FK1/Q1	60	800	845
3028/65/340/BD/FK1/Q1	65	700	829
3029/70/340/BD/FK1/Q1	70	640	817
3030/75/340/BD/FK1/Q1	75	560	816
3031/80/340/BD/FK1/Q1	80	500	811

Description: Concrete trapezium shaped surface spacer with burlings for vertical reinforcement, app. Length 340 mm, galvanized reinforcing wire, small contact to the formwork, surface for exposed concrete requirements, 1 spring steel clip for fixing

Cover: 25 - 80 mm

Performance Class: C50 / 60 = B 50

Compressive Strength: >50 N / mm² (50 MPA) after 28 days, cube 150mm

Material Composition: Sand 0-2, Cement CEMI, Plasticizer, w/c < 0,38

Test Certificate Nr. 220011095-15-01; Material Testing Institute MPA Nordrhein – Westfalen, Germany

- Tested on frost thaw resistance on the embedded spacer (CF Method)
- Tested on water penetration depth on the embed spacer
- Tested on thermal cycling

Spacers from BAG® Bauartikel GmbH are full filling the restriction F/T/A according to DBV leaflet „ Spacers according to Eurocode 2, Edition January 2011”

F = XF1, XF2, XF3 und XF4 T = XS1, XS2, XS3 A= XD1-XD3, XS1-XS3, XF2 and XF4, XA1-XA2.

We have to advice that the right use of our products has to be checked by the operator before every installing situation.

All test certificates are available on request.

Sprendlingen, den 2016-10-12

www.bag-bauartikel.de
zentrale@bagbauartikel.com

phone: +49 6701 93310
 fax: +49 6701 933115