

CONECTO SL 190.30.W Installation Guide (Niche version)

1. Prepare the montage niche before installation. Do it by cutting or milling the concrete. Installation place should be cleaned.

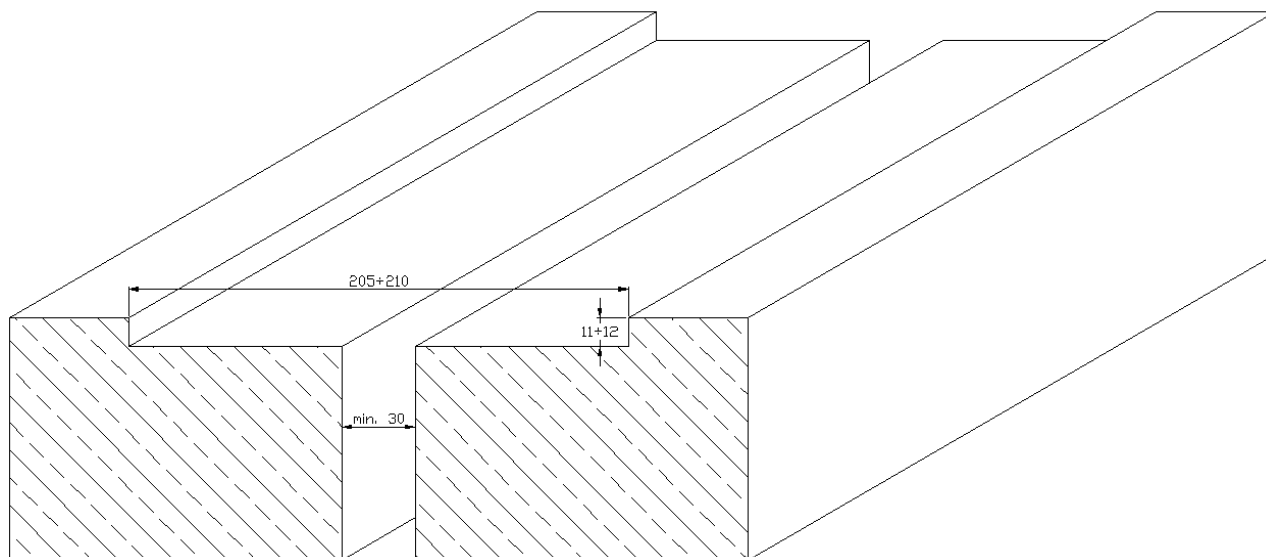

Sketch. 1 Profile niche

2. Prime the clean and prepared installation niche with system primer for concrete (eg. SAPOCOL GP2001 or similar).

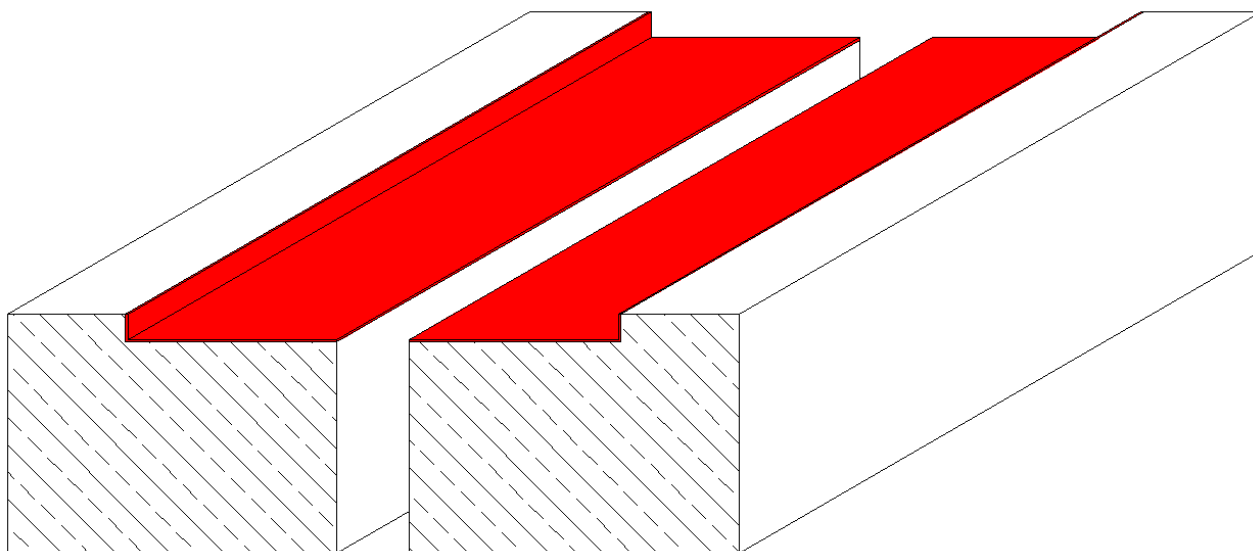

Sketch. 2 Concrete surface priming

3. Prepare for glueing elastomer: clean and activate the lower surface (glueing surface) with activator (eg. SOOLER ACTIVATOR 1001 Clear or similar).

4. Put on the primed concrete glue (eg. SOOPUR 500 or similar) with the 10x10mm teeth comb. Another solution is squeezing 2 rows of glue on each side of dilatation gap.

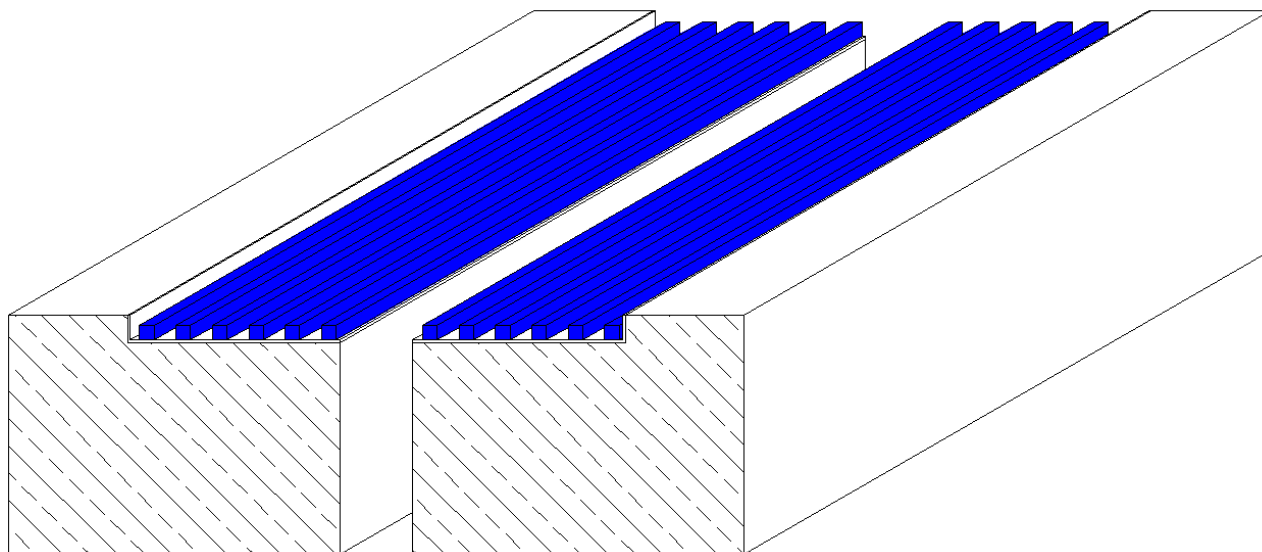

Sketch. 3 Sealing layer preparation

5. Shortly after glueing put on lower elastomer SL 190 and push it with aluminum profiles mounted with anchors for concrete (eg. Multi Monti MMS-F 7,5x60 or similar).

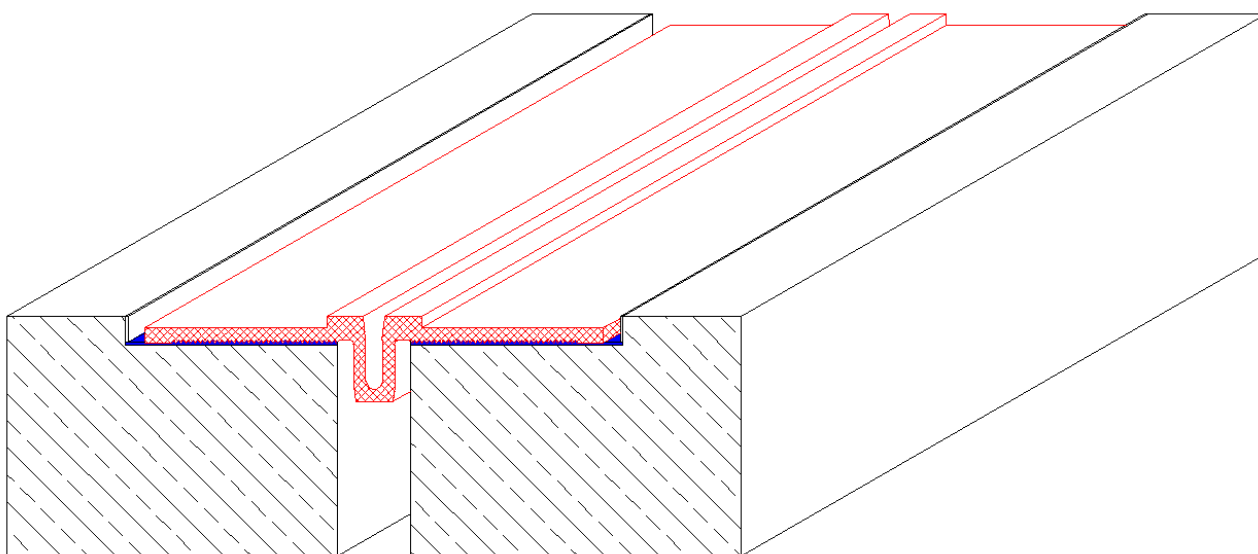

Sketch. 4 Elastomer placement

Profile should be placed to keep the 45mm distance between aluminum strips. Squeezing flat bars should be placed to keep 2mm free space between strips. Fix the first, middle and last anchor and after levelling of elastomer fix the remaining anchors. To make the profile waterproofing put in the hole small amount of sealing mastic (eg. SOOPUR 500 or similar).

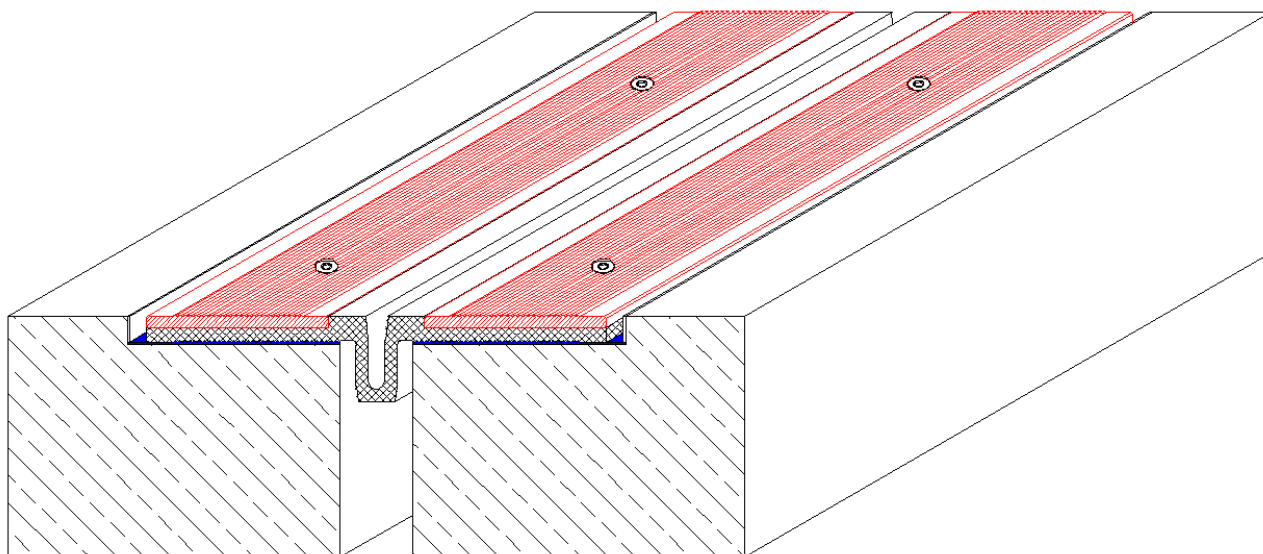

Sketch. 5 Squeezing flat bars installation

6. Fill the space between profile and niche edge with dilatation mastic (eg. SOOPUR 500 or similar).

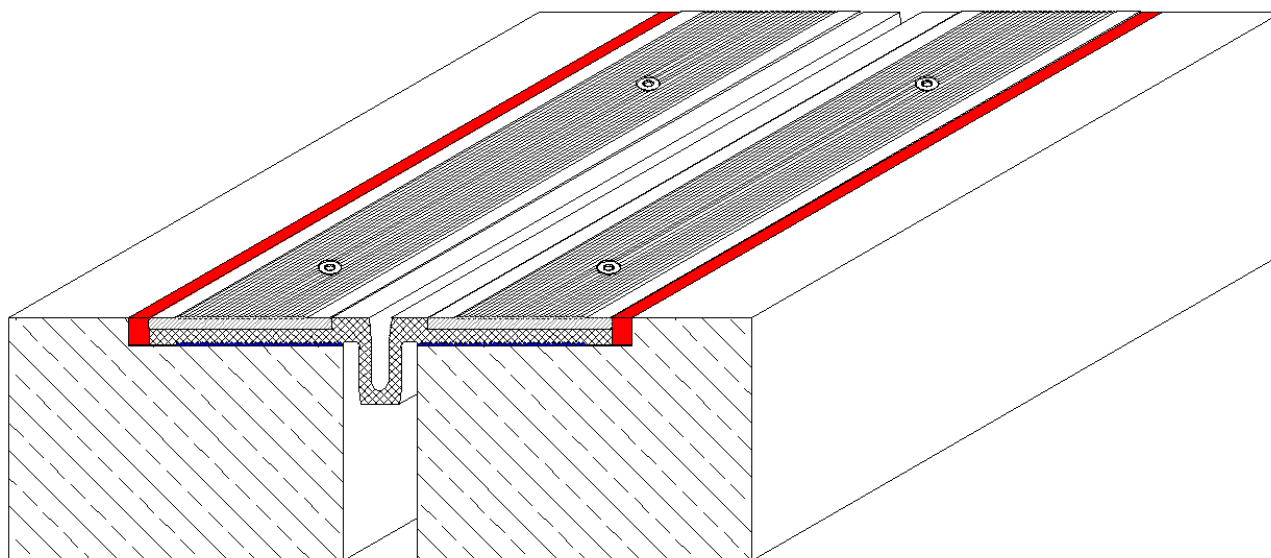

Sketch. 6 Sealing mastic filling spots

7. Remove remaining stains with the turpentine.
8. For the elastomer connection do it using EPDM glue (eg. SOOLER S2100 or similar) in accordance with producer recommendation.

9. "T", "L", "X" connection should be executed by glueing of properly cutted elastomer. It is possible for producer to prepare ready to use connectors.

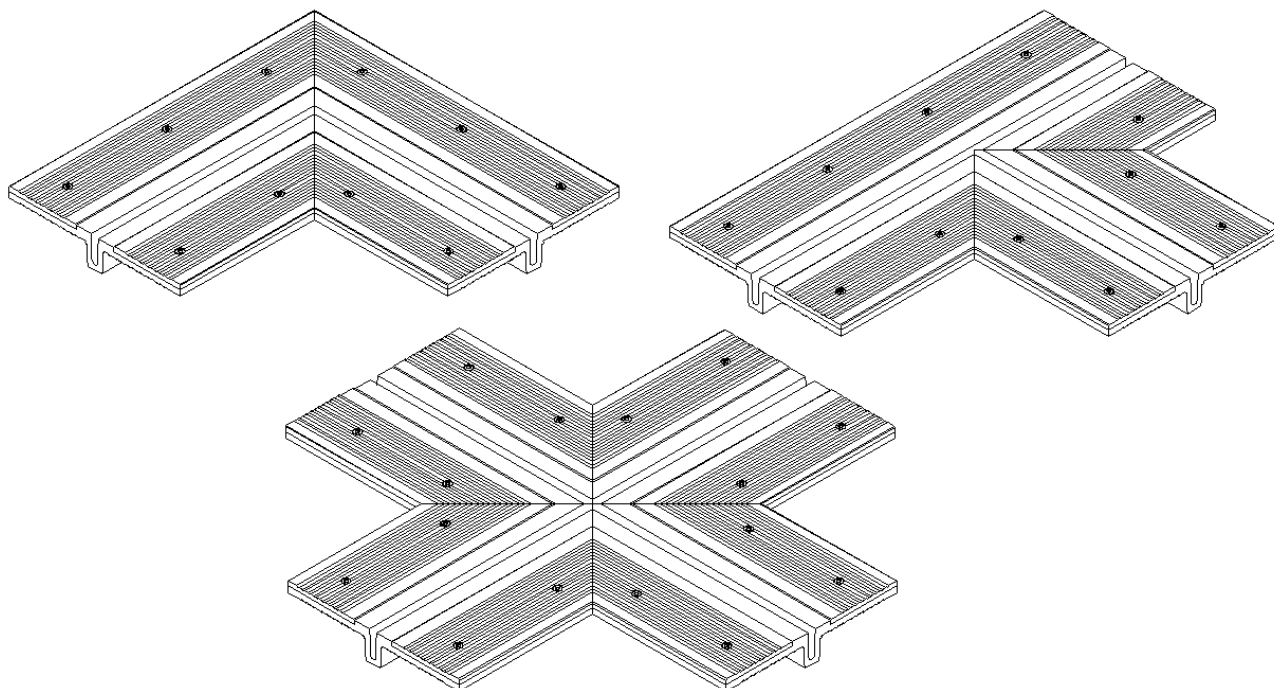

10. Wall connection is executed by cutting elastomer at 90° angle and prime glueing with EPDM glue in accordance with glue producer recommendation.

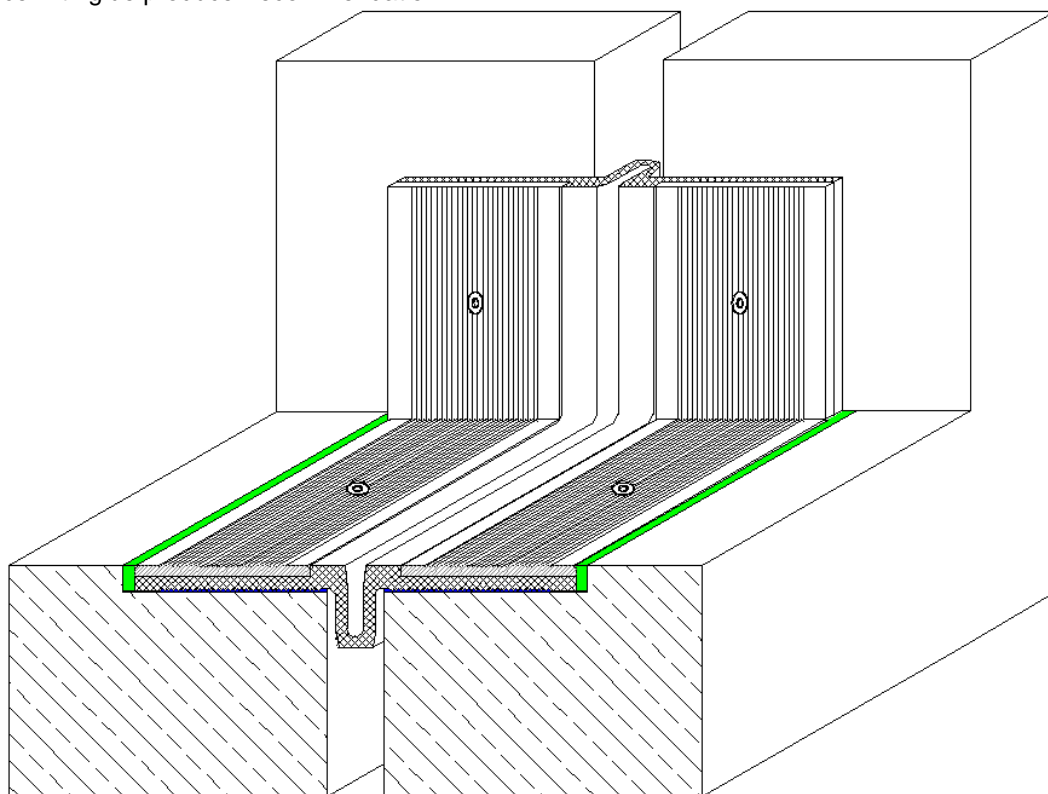

11. In case of dilatation along the wall there are angle profiles.

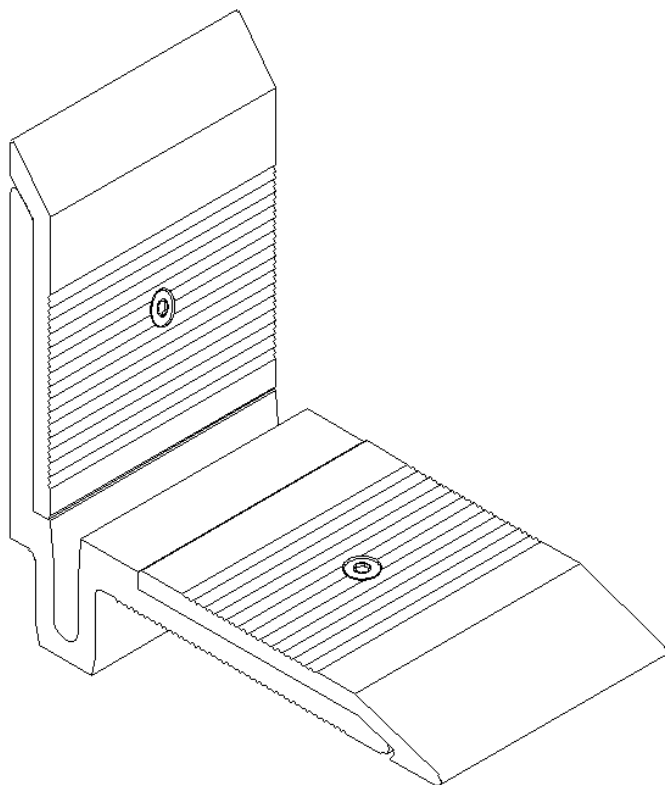

Comments:

- Using construction chemical should be only in accordance with producer's guide..
- Aluminum profiles should be mounted by non-stretching anchors.
- Producer is not responsible for the leaks in case of usage of other installation materials.