

Conecto Alu Installation Guide

1. Set up geodetic ordinates before installation of profile. Upper surface of profile should be at level „0” of the floor or target height.
2. Set up the straight line between farthest points of dilatation gap and make sure that anchoring places would be 3-4 cm from the edge of dilatation gap.
3. Clean and remove dust in place of installation.
4. Dilatation gap should be protected (e.g. Mineral wool or Styrofoam) to prevent getting mortar to the gap. Protection should be pushed up above target of levelling mortar..

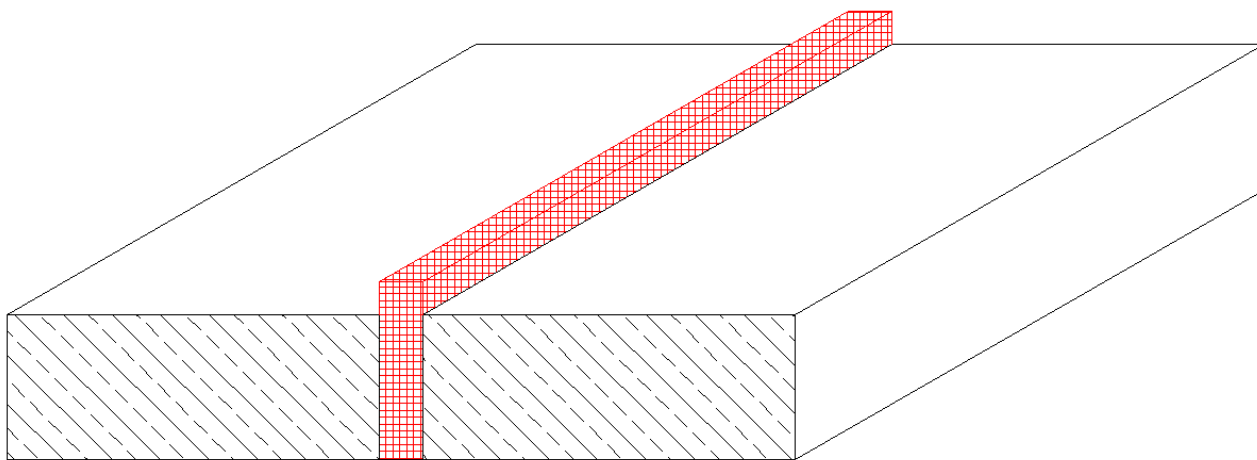

sketch. 1 dilatation gap protection

5. Set up the profiles in target place and level them with levelling bolts. Inner side of profile (compensator) should be moved along its axis ca. 5÷10 cm to set up profiles in proper way after hardening of the floor. Profiles should be mounted without taking off mounting clamps that set up the compensator in „0” level.

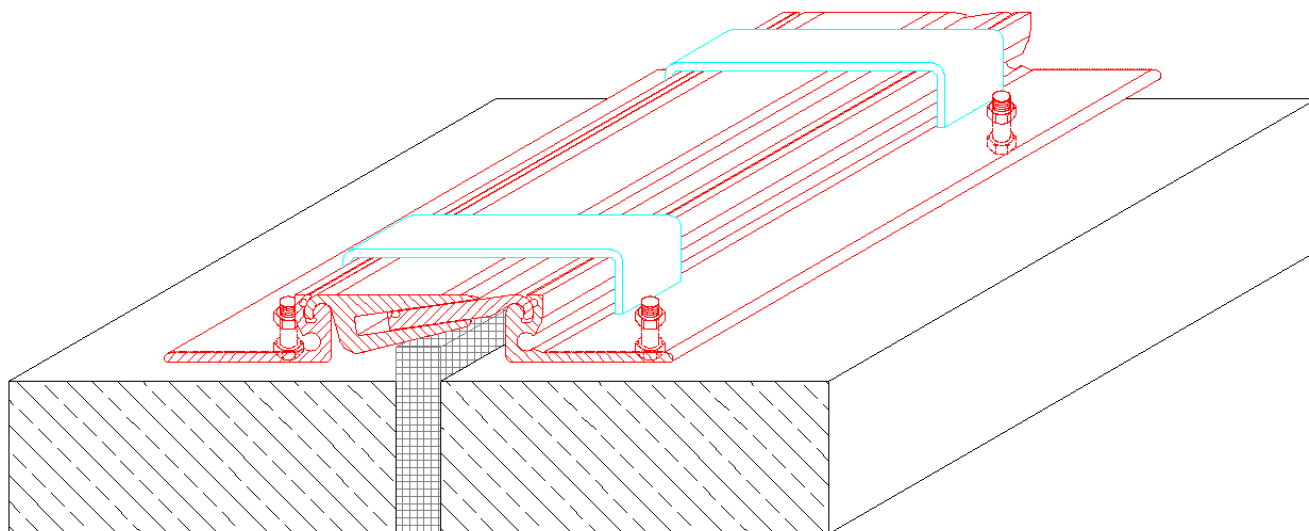

Sketch. 2 Profile footers levelling

6. Put on the mortar layer between footer of profile and surface.

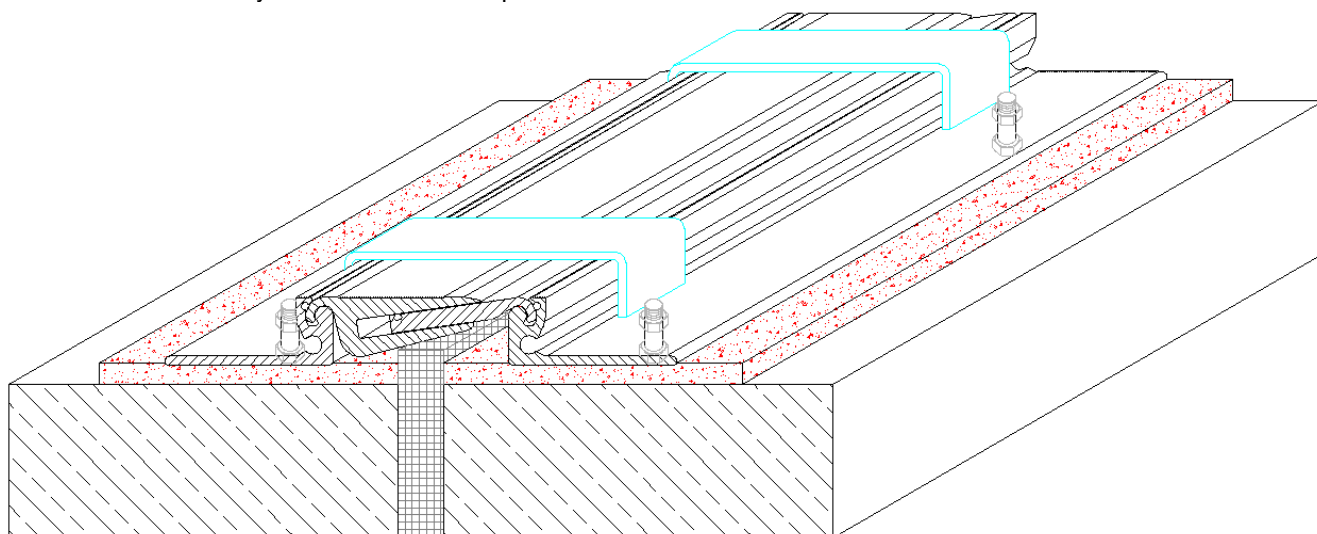

Sketch. 3 Levelling mortar spout

7. After hardening of mortar anchor the profiles to the ground. Anchors should be chosen regarding the type of the ground (we recommend anchors Multi Monti MMS-F 7,5x60 or similar) and unmount installation clamps. Space between anchors should not be bigger than 30 cm at every side of profile.

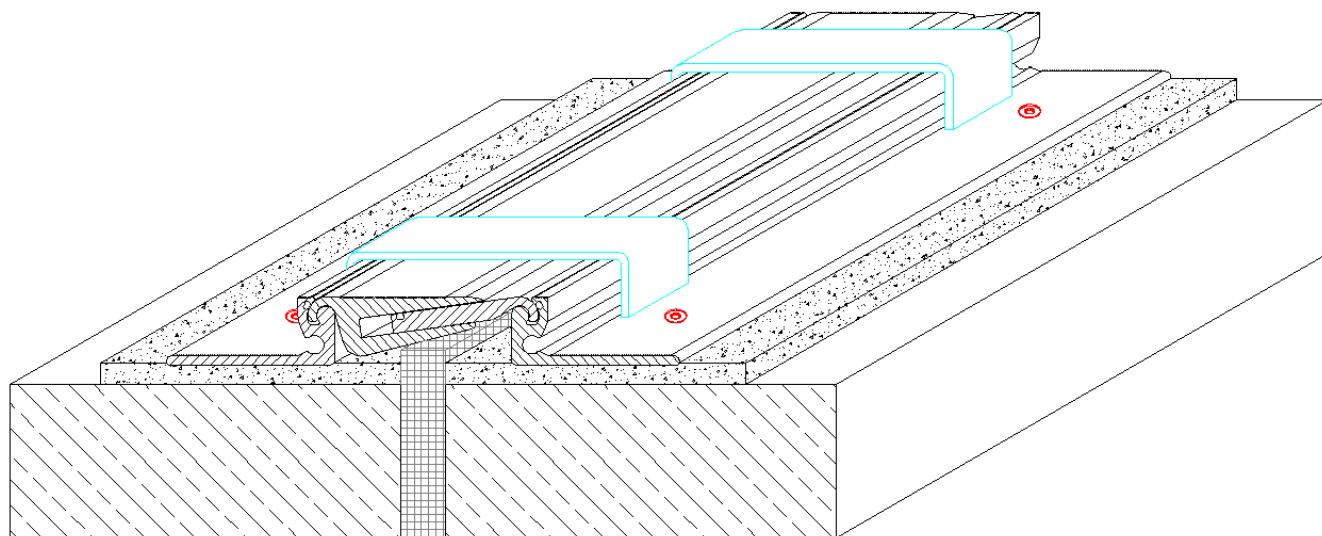

Sketch. 4 Profiles anchoring

8. Remove clamps and fill the space with concrete or mortar.

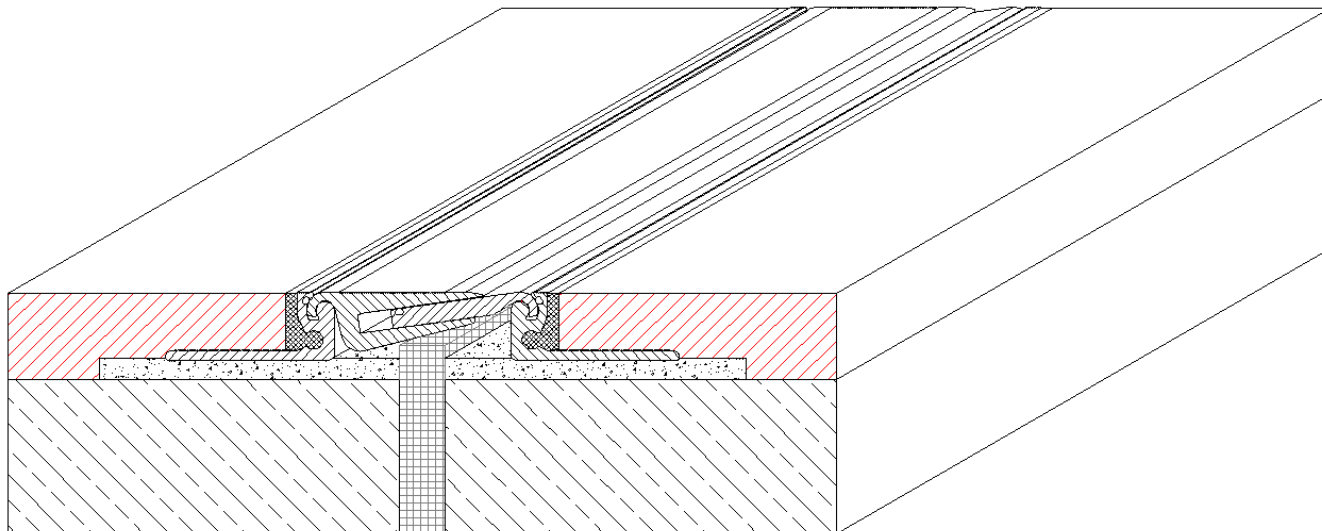

Sketch. 5 Floor layers execution

9. Ceramic tiles or similar should not be laid touching the profile. There should be 4 mm gap between profile and tile for dilatation mastic (eg. SOOPUR 500 or similar).

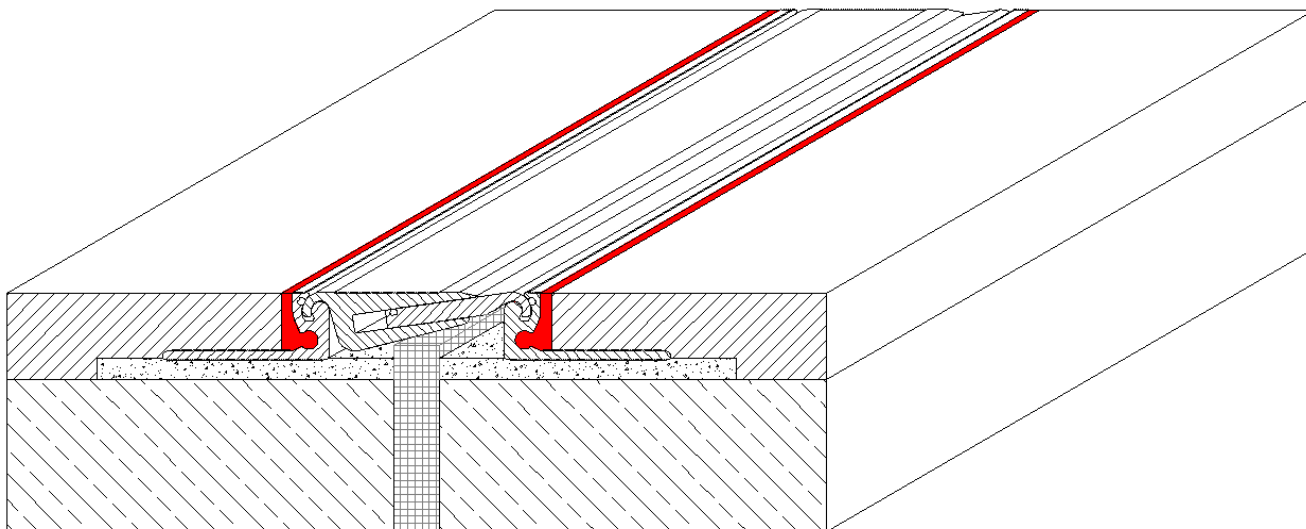

Sketch. 6 Filling the gap with dilatation mastic

10. "T", "L", "X" connection should be executed by cutting profile at 45 degrees angle.

Comments:

- Using construction chemical should be only in accordance with producer's guide..
- Aluminium profiles should be mounted by non-stretching anchors.